

**TENOR™ DIMMABLE SCONCE  
JLA36DKSC3DK Specification Sheet**

**FEATURES**

- Luxury decorative light design.
- Designed for easy, installation as a standalone vertical sconce.
- Warm, relaxing tones (3000K).
- Energy efficient LEDs.
- Dimmable LED using a standard residential dimmer that works with your home's existing wiring.
- Will operate in high humidity or damp spaces.
- Remotely mounted electrical enclosure.

Color Temperature	3000K
CRI	90+
R9 Value	60+
Delivered Lumens	605
Source Lumens	1776

**MATERIALS & CONSTRUCTION**

- Rust-free, aluminum and glass construction.
- Chrome plated back frame.
- Quality glass diffuser for consistent light output.
- Wired internally- Front access serviceability.
- TENOR™ Lights available with Chrome, Polished Nickel, Matte Black, and Brass finished end caps.

**CODES & STANDARDS**

- ETL certified (damp locations) to:
  - UL 8750
  - CSA C22.2 No. 250.13
- TITLE 24 certified

**DIMENSIONS**

Width: 1-3/8" (35mm)  
 Height: 36" (914mm)  
 Depth: 1.75" (44mm) when recessed  
 Net Weight: 5lbs

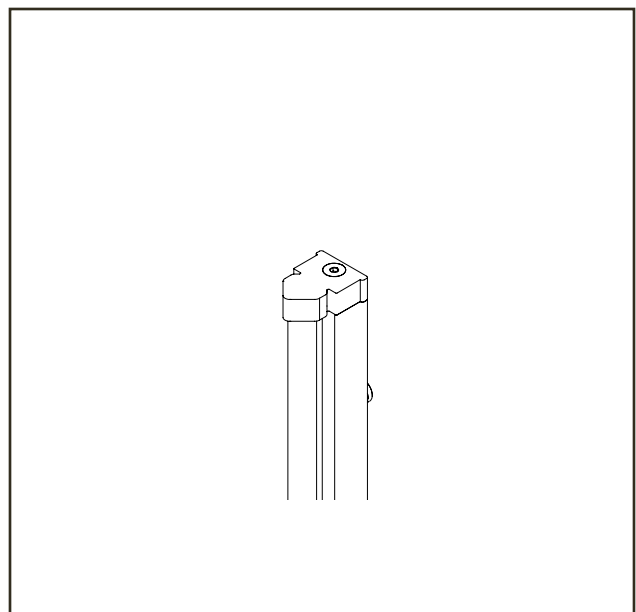

## MODEL NUMBER KEY

Product Line	Category	Dimensions	Body Type	Lamp Type	Qty.	Body Finish	Control Type	Option
L = Light	A36 = 1-3/8" (35mm) X 36" (914mm)	D = Diamond	K = T24 LED	S = Single	C = Chrome	3D = Dimmable , Warm White 3000K	K = Sconce	

## INSTALLATION

- Sold as individual unit.
- TENOR™ includes hardware for one sconce.

## ELECTRICAL SYSTEM

- Operates on 120VAC 102.6W 60Hz per fixture.
- Requires switch or dimmer (sold separately).
- ETL (US and Canada) listed for damp locations.
- Rough-in for electrical enclosure as shown in drawing.

## MORE INFORMATION

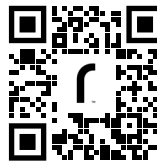

Scan the QR code to see the rough opening and electrical details found in the Inline 2.0 Light installation instructions.

Use the camera app on your mobile device to look at this QR code. This will allow you to quickly access web pages and other relevant documents.

